

# Raffle Entry Submittal 5<sup>th</sup>-8<sup>th</sup> Grade



## Learn the Sounds of Fire Safety™

firepreventionweek.org

©2021 NFPA®. Sparky® is a trademark of NFPA®.



**TIME TO COUNT AND TEST YOUR SMOKE ALARMS!**



How many  
smoke alarms  
do you have?

---

**DO THEY ALL WORK?**

---

How many beeps does  
a smoke alarm make?

Enter your name & grade here:

---



# How to make a Home Fire Escape Plan



**FIRE PREVENTION WEEK™**

NFPA® — The Official Sponsor of Fire Prevention Week Since 1922



Visit [Sparky.org](http://Sparky.org) for more activities!

- ☐ Draw a map of your home. Show all doors and windows.
- ☐ Visit each room. Find two ways out.
- ☐ All windows and doors should open easily. You should be able to use them to get outside.
- ☐ Make sure your home has smoke alarms. Push the test button to make sure each alarm is working.
- ☐ Pick a meeting place outside. It should be in front of your home. Everyone will meet at the meeting place.
- ☐ Make sure your house or building number can be seen from the street.
- ☐ Talk about your plan with everyone in your home.
- ☐ Learn the emergency phone number for your fire department.
- ☐ Practice your home fire drill!
- ☐ Make your own home fire escape plan using the grid provided on page 2.

## Sample Escape Plan

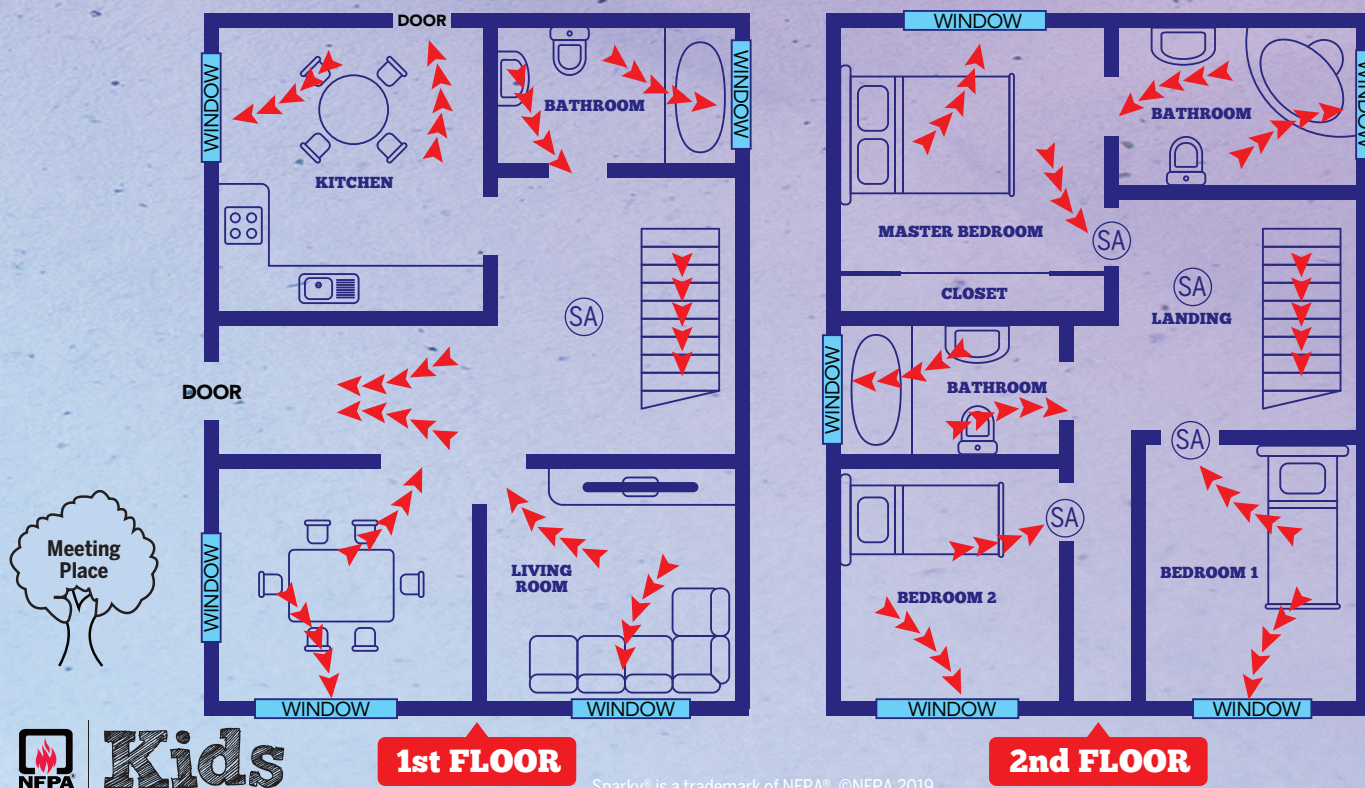

**Kids**

**1st FLOOR**

**2nd FLOOR**

Sparky® is a trademark of NFPA®. ©NFPA 2019



# How to make a **Home Fire Escape Plan**



NFPA® — The Official Sponsor of Fire Prevention Week Since 1922

- Draw a floor plan or a map of your home. Show all **doors** and **windows**.
- Mark **two ways out** of each room.
- Mark all of the **smoke alarms** with (SA). Smoke alarms should be in each sleeping room, outside each sleeping area, and on every level of the home.
- Pick a family **meeting place** outside where everyone can meet.
- Remember, **practice** your plan at least **twice a year**!

[illegible]

Get more information on smoke alarms and escape planning at [nfpa.org/factsheets](http://nfpa.org/factsheets).

PLAN 19